

Matching pump and filterchamber

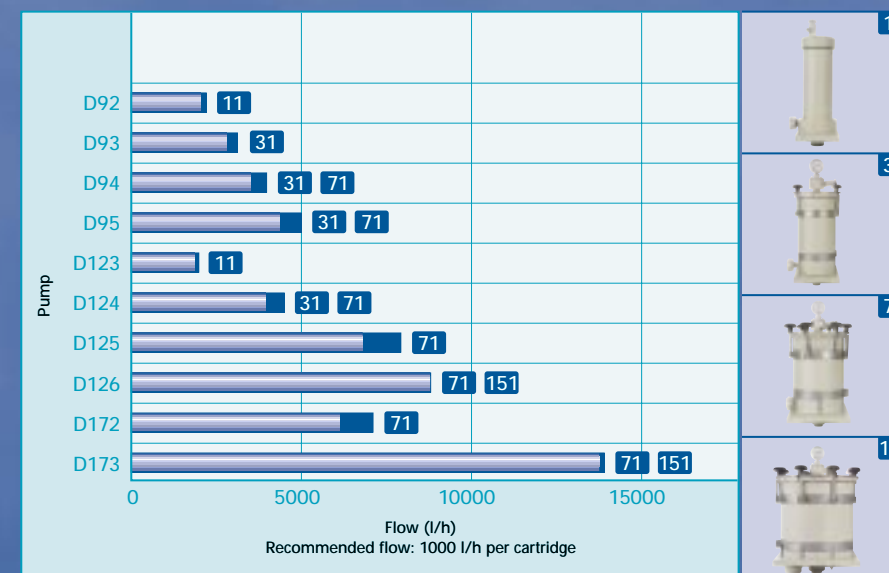
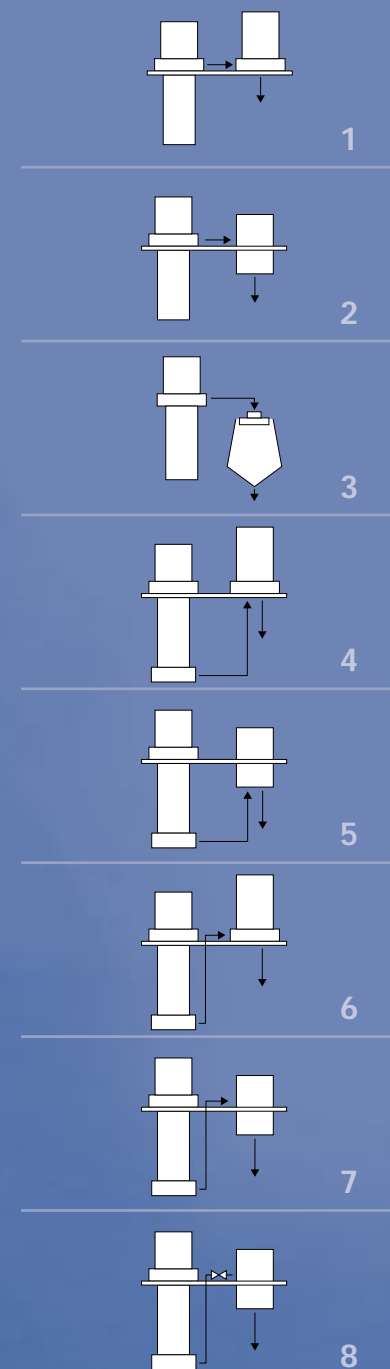

Submersible pumps

Design and realization: Comcorde Grafimedia, Bladel, The Netherlands

Why compromise quality ?

- Sealless.
- Self priming.
- Can run dry.
- 3 phase multi voltage capability.
- Full length motor shaft increases pump stability.
- Oversized motor bearings for greater shaft stability.
- Full length shaft sleeve preventing contamination.

- "No bolt, quick mount" - system provides easy installation.
- Connection for suction extension pipe.
- Longer immersion length minimizes air problems.
- Max temp PP 80°C, PVDF 100°C, SS316 100°C .
- PP motor parts for max. chemical protection.
- Two component Polyurethane motor coating for excellent chemical resistance.

- All outlet couplings available with CPVC union end for CPVC and PVC pipework.
- Option:
 - Hose connections.

- Ideal pump for use with frequency converter.
- Toolkit available for proper maintenance.

- Options:
 - Customised mounting plates.
 - Out-of-tank model for most types.

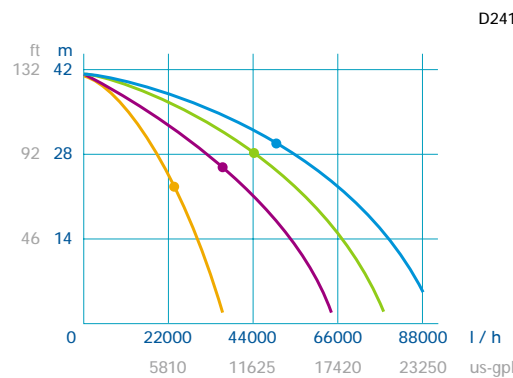
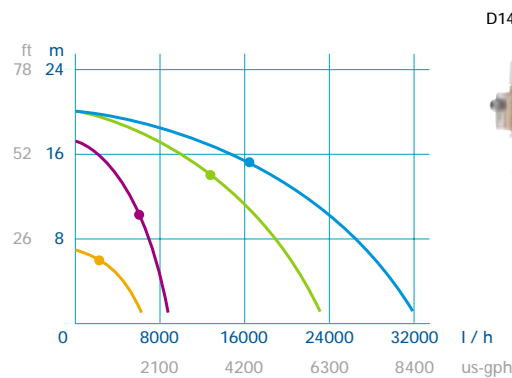
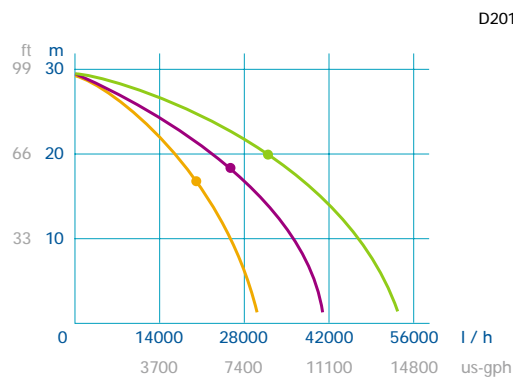
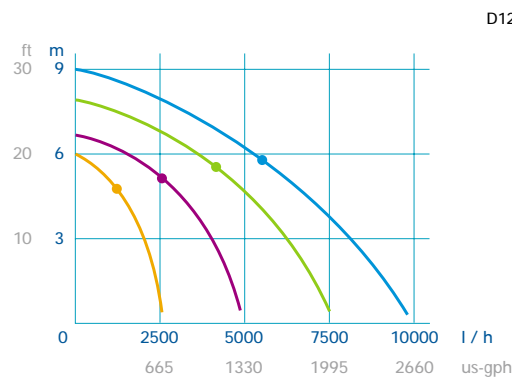
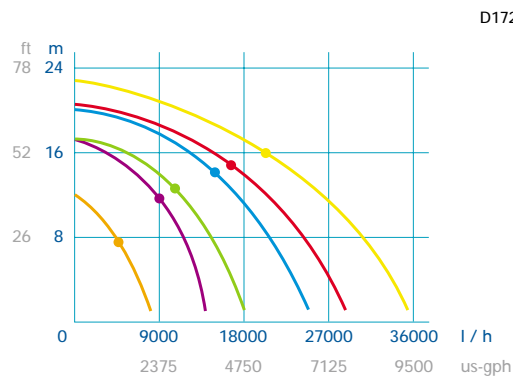
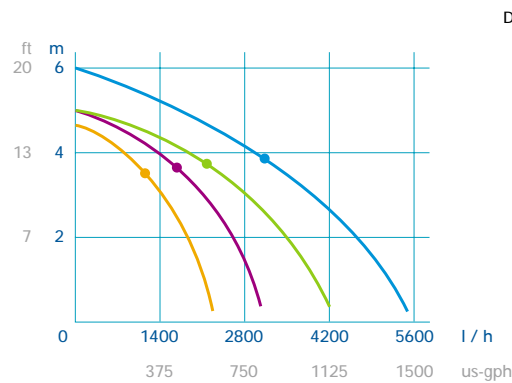

Hendor standard connections

PP, PVDF, CPVC

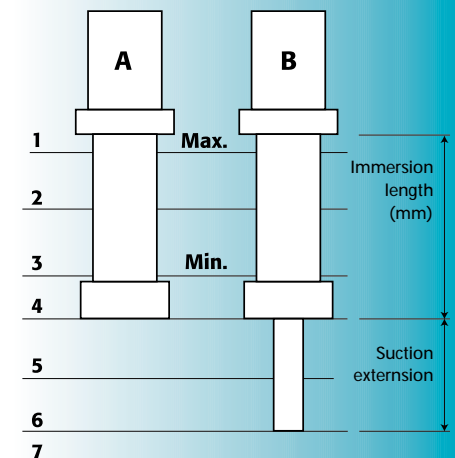

Info 21525 / R0 30-01-2002

Q l / h	H m	Type	Material	kW	Out (mm) d/DN	Immersion length (mm)
2000	5	D92	PP/PVDF	0,12	25/20	270
3000	5,5	D93		0,18		
4000	5,5	D94		0,25		
5000	6	D95		0,37		
1800	7	D123	PP/PVDF	0,18	32/25	400
4500	7	D124		0,25		
7500	8	D125		0,37		
9000	9	D126		0,55		

5000	6	D149	SS*	0,37	3/4" B SP	270
8000	17	D151		0,75	1" B SP **	350
18000	17	D153		1,1	1-1/4" B SP **	384
30000	17	D154		1,5	1-1/4" B SP **	384

1 phase motors on request

SS* = AISI 316

**discharge pipe is optional

Q l / h	H m	Type	Material	kW	Out (mm) d/DN	Immersion length (mm)
7000	12	D172	PP/PVDF	0,55	25/20	400
14000	16	D173		0,75	32/25	
18000	16	D174		1,1	40/32	
24000	20	D175		1,5	40/32	
28000	20	D176		2,2	40/32	
35000	22	D177		3	40/32	

30000	30	D201	PP/NPP	4	50/40	400
40000	30	D202		5,5		
50000	30	D203		7,5		

35000	42	D241	PP/NPP	4	63/50	400
60000	42	D242		5,5	63/50	
80000	42	D243		7,5	63/50	
90000	42	D244		9	75/65	



Best Efficiency Point (BEP).
Water 20° C., 50/60 Hz.



Technical leaflets available for each model.